

CHATTAHOOCHEE RIVER

716' +/- ALONG HIGH WATER MARK IS PROPERTY LINE

N/E
EXECUTIVE ENTERPRISES, INC.

LINE	BEARING	DISTANCE
L1	N 47°12'06" W	12.06'
L2	N 68°13'06" W	50.44'
L3	N 61°51'01" W	113.00'
L4	N 54°07'45" W	179.83'
L5	N 54°39'53" W	178.14'
L6	N 53°52'51" W	178.14'
L7	N 53°32'52" W	113.00'
L8	N 50°32'52" W	91.63'
L9	N 61°47'47" W	34.27'

CURVE	RADIUS	ARC LENGTH	CHORD	BEARING	DELTA ANGLE
C1	123.71'	114.40'	110.58'	S 39°50'02" W	67°54'00"

NOTES:

1. REFERENCES FOR THE BOUNDARY INFORMATION SHOWN HEREON IS MADE TO PLAT BOOK 4, PAGE 210 WHICH IS LOCATED IN GWINNETT COUNTY PUBLIC RECORDS.
2. HORIZONTAL DATUM SHOWN HEREON IS BASED UPON THE PLAT IN NOTE 1 ABOVE.
3. A PORTION OF THIS PROPERTY LIES WITHIN A SPECIAL FLOOD HAZARD AREA AS IDENTIFIED ON F.I.R.M. COMMUNITY PANEL No. 1335C 0053G DATED JUNE 18, 2010. THE APPROXIMATE 100 YEAR FLOOD HAZARD LINE IS PLOTTED HEREON THE SURVEY.
4. NO ATTEMPT HAS BEEN MADE TO IDENTIFY WETLANDS OR DELINEATE STREAMS BY THE SURVEYOR OR A THIRD PARTY.
5. THE LOCATIONS OF UNDERGROUND UTILITIES SHOWN HEREON IS BASED ON ABOVE GROUND STRUCTURES AND INFORMATION SUPPLIED TO THE SURVEYOR. THE SURVEYOR MAKES NO WARRANTY AS TO THE ACCURACY OF THE UTILITIES SHOWN HEREON. ADDITIONAL BURIED UTILITIES OR STRUCTURES MAY EXIST. THE SURVEYOR MAKES NO CERTIFICATION AS TO THE ACCURACY AND COMPLETENESS OF THE LOCATIONS SHOWN HEREON.
6. NO ABSTRACT OF TITLE, TITLE COMMITMENT, OR RESULTS OF TITLE SEARCHES WERE SUPPLIED TO THE SURVEYOR. THERE MAY BE OTHER MATTERS OF RECORD THAT AFFECT THIS PROPERTY.
7. VULNERABILITY CODES SHOWN HEREON WERE PROVIDED BY GWINNETT COUNTY PLANNING AND DEVELOPMENT.

- 1. IPS=Iron Pin Set With Cap
- 2. RIB=Rebar In Place
- 3. CTR=Concrete Monument Found
- 4. CTR=Crmp Top Pipe Found
- 5. SRF=Solid Rod Found
- 6. N-S=North Set
- 7. MAG=Magnetic Nail
- 8. TPA=Tap Pinned Number
- 9. P-L=Property Line
- 10. B-L=Branch of Way
- 11. B-L=Building Line
- 12. B-C=Back of Curb
- 13. B-S=Back of Street
- 14. L-L=Land Lot
- 15. L-L=Land Lot Line
- 16. D.B.=Double Block Page
- 17. P.B.=Plate Book/Page
- 18. PRO=Point of Beginning
- 19. DIS=Discontinuity Element
- 20. SEC=Sectional Sewer
- 21. REC=Reinforced Concrete Pipe
- 22. PVC=Polyvinyl Chloride Pipe
- 23. CO=Clear Out
- 24. MH=Manhole
- 25. DWG=Double Wing Catch Basin
- 26. SW=Single Wing Catch Basin
- 27. D=Drop Inlet
- 28. G=Gate Inlet
- 29. JP=Junction Box
- 30. P=Pulling Pole
- 31. W=Water Valve
- 32. P=Fire Hydrant
- 33. W=Water Meter
- 34. G=Gas Meter
- 35. G=Gas Valve
- 36. W=Water Valve
- 37. G=Gas Valve
- 38. S-S=Square Feet
- 39. E=Edge of Paving
- 40. O.S.D.=Outside Dimension
- 41. RM=Record Sheet Measure
- 42. P=Parking Space Count
- 43. Light Pole
- 44. P=Private Indication Valve
- 45. FHM=Flood Hazard Map
- 46. FHM=Flood Insurance Rate Map
- 47. DYL=Double Yellow Line
- 48. SYL=Single Yellow Line
- 49. R=Right of Way
- 50. S=Stream
- 51. S=Stream
- 52. S=Stream
- 53. S=Stream
- 54. S=Stream
- 55. S=Stream
- 56. S=Stream
- 57. S=Stream
- 58. S=Stream
- 59. S=Stream
- 60. S=Stream
- 61. S=Stream
- 62. S=Stream
- 63. S=Stream
- 64. S=Stream
- 65. S=Stream
- 66. S=Stream
- 67. S=Stream
- 68. S=Stream
- 69. S=Stream
- 70. S=Stream
- 71. S=Stream
- 72. S=Stream
- 73. S=Stream
- 74. S=Stream
- 75. S=Stream
- 76. S=Stream
- 77. S=Stream
- 78. S=Stream
- 79. S=Stream
- 80. S=Stream
- 81. S=Stream
- 82. S=Stream
- 83. S=Stream
- 84. S=Stream
- 85. S=Stream
- 86. S=Stream
- 87. S=Stream
- 88. S=Stream
- 89. S=Stream
- 90. S=Stream
- 91. S=Stream
- 92. S=Stream
- 93. S=Stream
- 94. S=Stream
- 95. S=Stream
- 96. S=Stream
- 97. S=Stream
- 98. S=Stream
- 99. S=Stream
- 100. S=Stream

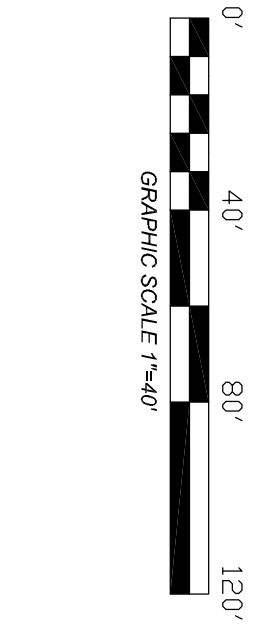

CLOSURE STATEMENT

FIELD INFORMATION FOR THIS SURVEY WAS OBTAINED WITH A TRIANGLE SET TO THE SURVEY.

THIS MAP OR PLAT HAS NOT BEEN CALCULATED OR CHECKED FOR ACCURACY. THE SURVEYOR MAKES NO WARRANTY AS TO THE ACCURACY OF THE LOCATIONS SHOWN HEREON. ADDITIONAL BURIED UTILITIES OR STRUCTURES MAY EXIST. THE SURVEYOR MAKES NO CERTIFICATION AS TO THE ACCURACY AND COMPLETENESS OF THE LOCATIONS SHOWN HEREON.

THE FIELD DATA WERE TAKEN WITH A TOTAL STATION OR A TOTAL STATION WITH AN OPEN CLOSURE. THE FIELD DATA WAS PROCESSED WITH NO HORIZONTAL ADJUSTMENT.

CERTIFICATION

I HEREBY CERTIFY THAT THIS PLAT IS A CORRECT REPRESENTATION OF THE LAND PLATTED AND HAS BEEN PREPARED IN CONFORMITY WITH THE MINIMUM STANDARDS AND THE REQUIREMENTS OF THE STATE OF GEORGIA.

GARY S. HARVIN, JR.
Georgia Registered Land Surveyor No. 3105

BOUNDARY SURVEY FOR: RIVERVIEW ESTATES RECREATION AREA

LAND LOT 329, 6TH LAND DISTRICT,
GWINNETT COUNTY, GEORGIA
TAX PARCEL 6329 019

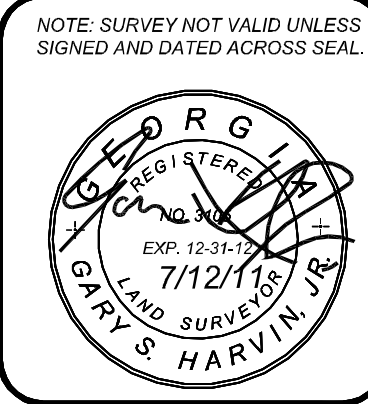

DATE:	ISSUE	NO.	DESCRIPTION	DATE
JULY 12, 2011				
SCALE: HORIZ.				
1"=40'				
ACREAGE: 5.263				
LAND LOT(S): 329				
DISTRICT: 6	SECTION:			
CITY:				
COUNTY: GWINNETT	STATE: GEORGIA			
SURVEYED: MG	DRAWN: GSH			
CHECKED: GSH	APPROVED: GSH			
PROJECT #: 11212				